

# BSW(Ww) - HSS snijkussens

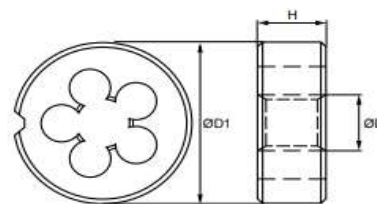

maykeTag  
Prototap

Artikelnr: **5653**

## BSW

|                 | D     | D1  | H  |
|-----------------|-------|-----|----|
| BSW 1/16 x 60   | 1,59  | 16  | 5  |
| BSW 3/32 x 48   | 2,38  | 16  | 5  |
| BSW 1/8 x 40    | 3,18  | 20  | 5  |
| BSW 5/32 x 32   | 3,97  | 20  | 5  |
| BSW 3/16 x 24   | 4,76  | 20  | 7  |
| BSW 7/32 x 24   | 5,56  | 20  | 7  |
| BSW 1/4 x 20    | 6,35  | 20  | 7  |
| BSW 5/16 x 18   | 7,94  | 25  | 9  |
| BSW 3/8 x 16    | 9,53  | 30  | 11 |
| BSW 7/16 x 14   | 11,11 | 30  | 11 |
| BSW 1/2 x 12    | 12,7  | 38  | 14 |
| BSW 9/16 x 12   | 14,29 | 38  | 14 |
| BSW 5/8 x 11    | 15,88 | 45  | 18 |
| BSW 3/4 x 10    | 19,05 | 45  | 18 |
| BSW 7/8 x 9     | 22,23 | 55  | 22 |
| BSW 1" x 8      | 25,4  | 55  | 22 |
| BSW 1.1/8 x 7   | 28,58 | 65  | 25 |
| BSW 1.1/4 x 7   | 31,75 | 65  | 25 |
| BSW 1.3/8 x 6   | 34,93 | 65  | 25 |
| BSW 1.1/2 x 6   | 38,1  | 65  | 25 |
| BSW 1.1/2 x 6   | 38,1  | 75  | 30 |
| BSW 1.5/8 x 5   | 41,28 | 75  | 30 |
| BSW 1.3/4 x 5   | 44,45 | 90  | 36 |
| BSW 1.7/8 x 4,5 | 47,63 | 90  | 36 |
| BSW 2" x 4,5    | 50,8  | 90  | 36 |
| BSW 2.1/4 x 4   | 57,15 | 105 | 36 |
| BSW 2.1/2 x 4   | 63,5  | 105 | 36 |
| BSW 2.3/4 x 3,5 | 69,85 | 120 | 36 |
| BSW 3" x 3,5    | 76,2  | 120 | 36 |